

Flange Type with screw Linear guide rail and Slider Assy

Note No.

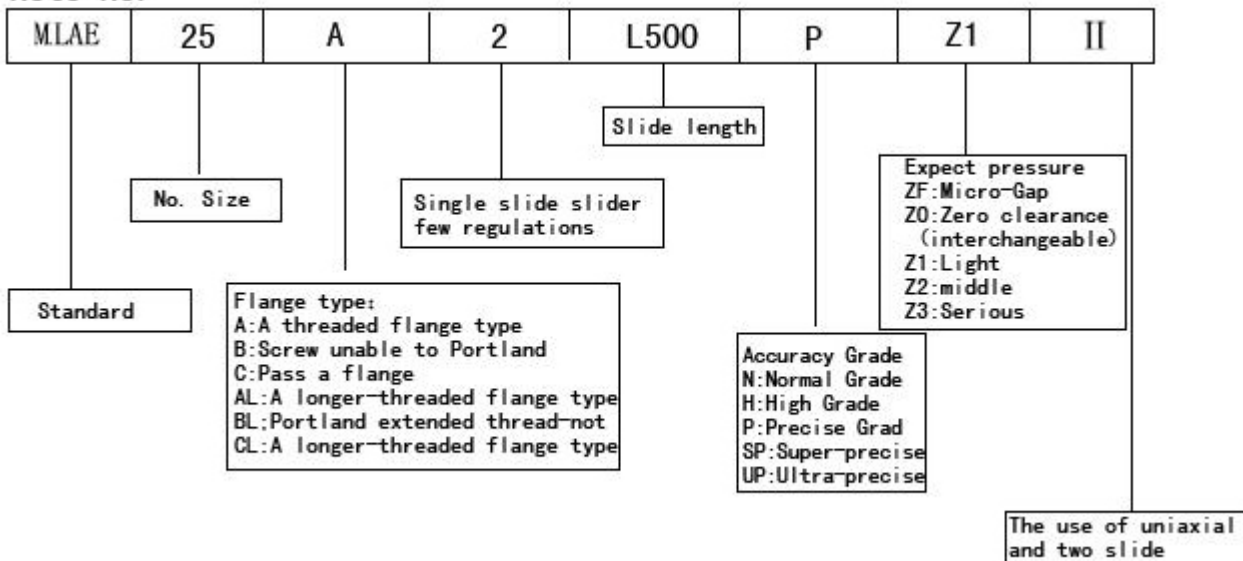

The roller linear guide assembly consists of **guide, slide, steel ball, reverser, retainer, seal end and baffle** etc. When the guide and slide act relative movement, the steel ball will roll along the four annealed precise ground raceways on the guide and enter into return hole through **reversal unit (reverser)** at the end of slide before entering into raceways, the steel ball rolls recurrently in this way. The two ends of reverser are equipped with **dust-proof seal ends** to prevent dust and detritus from entering into inner slide effectively

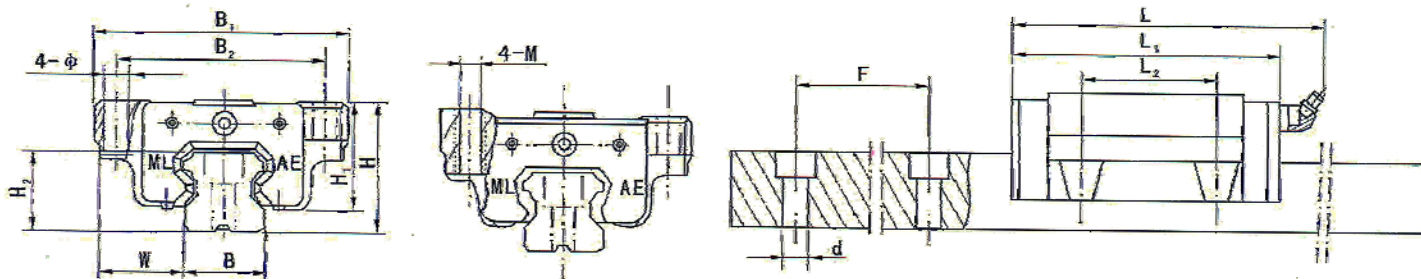

Model No	Size After Assy		Slider Installation Size							Guide Rail Installation Size				
	H	W	B1	B2	H1	L	L1	L2	M	Φ	B	H2	F	d
MLAE 15 A	24	15.5	47	38	19.5	60	49	30	M5	4	15	15	60	4.5
MLAE 20 A	30	21.50	63	53	24.5	82	71	40	M6	6	20	18	60	6
MLAE 25 A	36	23.50	70	57	29	96	85	45	M8	7	23	22	60	7
MLAE 25 AL	36	23.50	70	57	29	115	104	45	M8	7	23	22	60	7
MLAE 30 A	42	31	90	72	34	107	96	52	M10	9	28	26	80	9
MLAE 30 AL	42	31	90	72	34	128	117	52	M10	9	28	26	80	9
MLAE 35 A	48	33	100	82	40	127	113	62	M10	9	34	29	80	9
MLAE 35 AL	48	33	100	82	40	146	132	62	M10	9	34	29	80	9
MLAE 45 A	60	37.50	120	100	51	149	135	80	M12	11	45	38	105	14
MLAE45 AL	60	37.50	120	100	51	177	163	80	M12	11	45	38	105	14

Without Flange with Screw Square type Linear guide rail and Slider assy

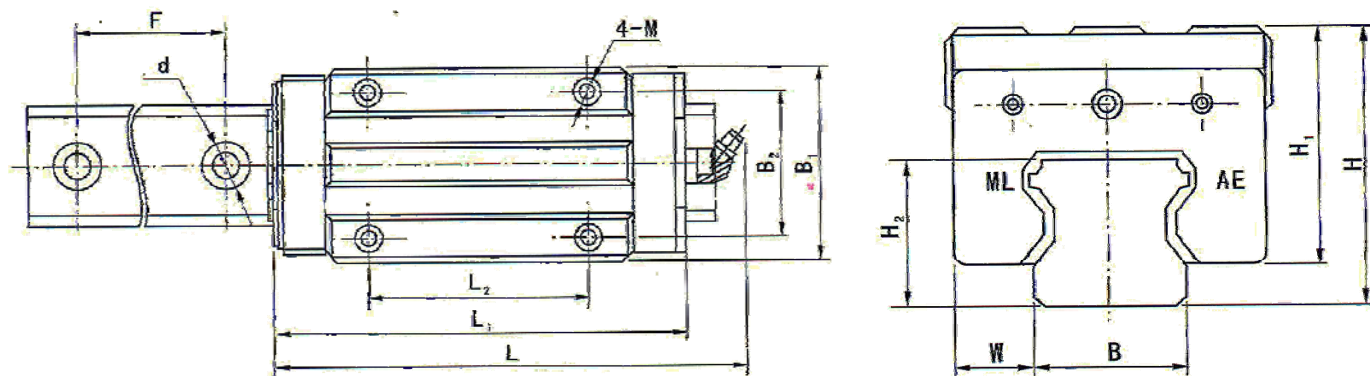

Model No	Size After Assy		Slider Installation Size							Guide Rail Installation Size			
	H	W	B1	B2	H1	L	L1	L2	M	B	H2	F	
MLAE 15 B	28	9	31	26	23.5	60	49	26	M4	15	15	60	4.5
MLAE 20 B	30	12	44	32	24.5	82	71	36	M5	20	18	60	6
MLAE 25 B	40	12.5	48	35	33	96	85	35	M6	23	22	60	7
MLAE 25 BL	40	12.5	48	35	33	115	104	45	M6	23	22	60	7
MLAE 30 B	46	16	60	40	38	107	96	40	M8	28	26	80	9
MLAE 30 BL	46	16	60	40	38	128	117	40	M8	28	26	80	9
MLAE 35 B	55	18	70	50	47	127	113	50	M8	34	29	80	9
MLAE35 BL	55	18	70	50	47	146	132	50	M8	34	29	80	9
MLAE 45 B	69	19.5	84	60	60	149	135	60	M10	45	38	105	14
MLAE 45 BL	69	19.5	84	60	60	177	163	60	M10	45	38	105	14